

## 1. Description

The BA494G-SS panel mounting kit secures a 'G' field mounting stainless steel instrument to an instrument panel. It preserves the ingress and impact protection of the 'G' instrument and provides an IP66 seal between the front and rear of the instrument panel.

## 2. Certification

A stainless steel 'G' enclosure panel mounted using a BA494G-SS Panel Mounting Kit is one of the mounting configurations included in IECEx component certificate IECEx CML 18.0071IU. This confirms that after thermal endurance and impacting the 'G' stainless steel enclosure provides IP66 protection.

## 3. Contents

The BA494G-SS panel mounting kit comprises:

Quantity	Description	BEKA part number
1	Front of panel gasket	069-038
1	Rear of panel gasket	069-036
4	M5 x 25mm SS screw pan head	065-076
8	M5 SS spring washer	067-030
4	M5 x 26 SS spacer	063-039
4	M6 x 12mm SS screw cheese head	055-078

## 4. Installation procedure

Before starting installation ensure that the edges of the panel cut-out and holes are de-burred.

1. Remove the front assembly of the BEKA 'G' stainless steel instrument from the back-box by unscrewing the four M6 'A' screws. Carefully remove the four corner 'A' screws from the front assembly, remove the spring washers and discard the screws. Fit the M6 washers to the four new M6 x 12mm cheese head screws and replace in the front assembly.
2. Remove and discard the existing front assembly gasket and replace with the new front of panel moulded gasket.
3. Fit a new M5 spring washer to each of the new M5 x 26mm spacers. Present the 'G' instrument front assembly to the front of the instrument panel and secure with the four new M5 spacers from the rear of the instrument panel. Ensure that the gasket is correctly positioned before tightening the spacers.
4. Fit the new rear of panel moulded gasket to the instrument back-box. Install a suitable M20 cable gland in the instrument back-box and feed the connecting cable through the gland before connecting it to the instrument terminals.
5. Fit a new M5 washer to each of the new M5 x 25mm pan head screws. Carefully position the instrument back-box over the terminals ensuring that only adequate cable remains inside the instrument back-box. Secure the back-box in position with the four M5 x 25mm screws. Ensure that the gasket is correctly positioned before tightening the four M5 screws and the cable gland.

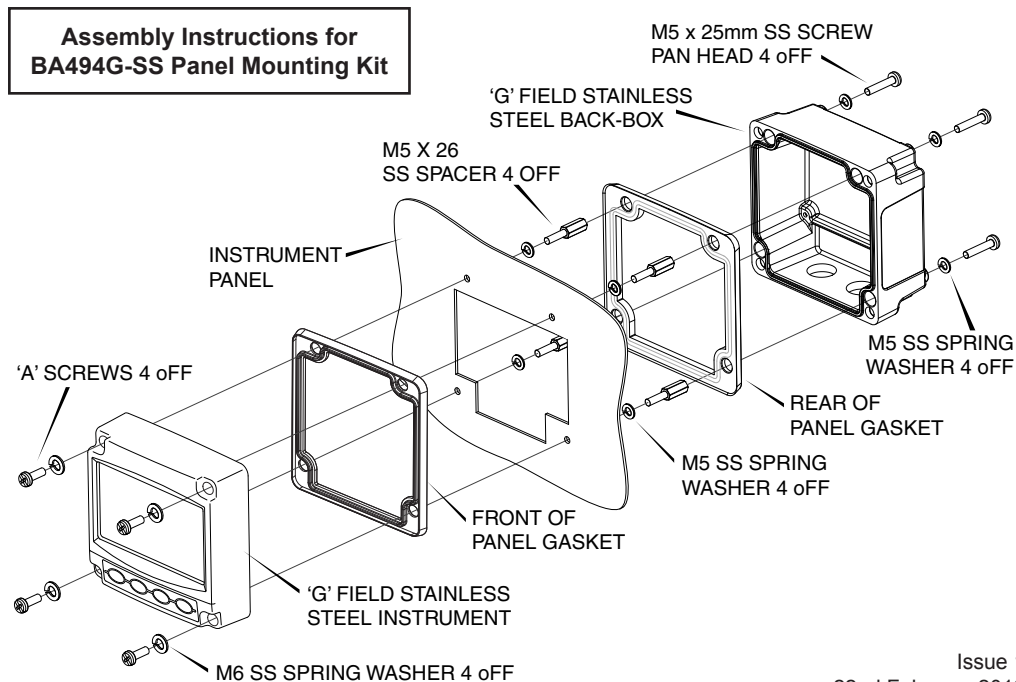

### CUTOUT DIMENSIONS

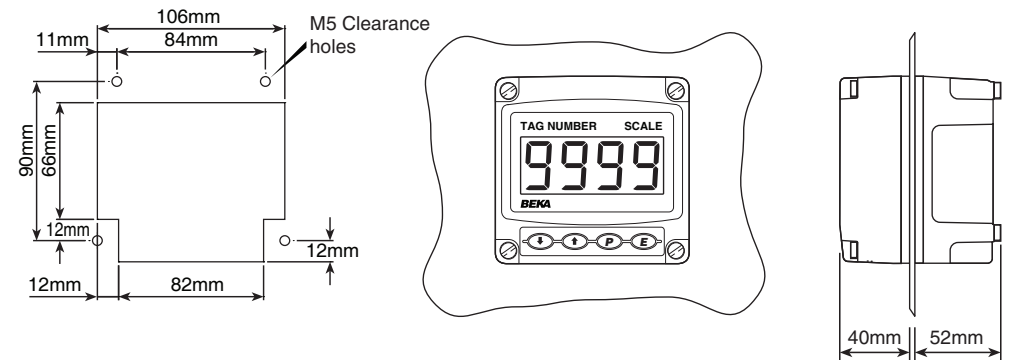

INSTRUMENT PANEL THICKNESS: 2 to 5mm

**Note:** For panel thickness greater than 5mm the four hexagon headed M5 x 16mm screws should be replaced by longer screws.

## BEKA associates Ltd.

Old Charlton Road, Hitchin, Hertfordshire, SG5 2DA UK. Tel: (01462) 438301  
 Fax: (01462) 453971 e-mail: [sales@beka.co.uk](mailto:sales@beka.co.uk) website: [www.beka.co.uk](http://www.beka.co.uk)